

Installation of Wall cabinet

2 Installation Procedure

- a) Check the drawing
- b) Position
- c) Unpack cartons
- d) Wall cabinet assembly
- e) Base cabinet assembly
- f) Wall cabinet installation
- g) Base cabinet installation
- h) Countertop installation
- l) Accessory installation
- j) Clean

3 Check the Drawing

3.1 Find out the each cabinet and mark on the drawing

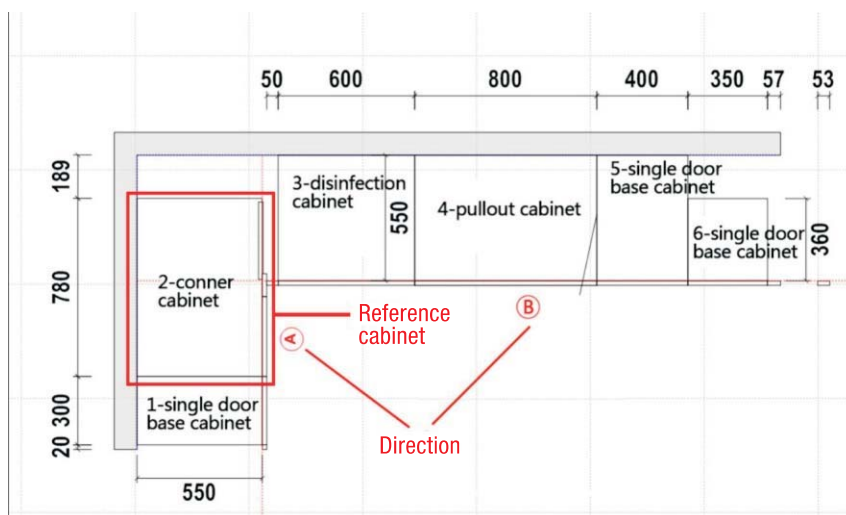

3.2 Confirm the "Installation Direction (from which direction to which) " according to the drawing.

4 Unpack the cartons

4.1 Check the quantity of the cartons to make sure no carton is missing



4.2 Unpack the carton



4.3 Sort out the panels



4.4 Open the accessory carton



4.5 Sort out the accessory



5 Assemble the Wall Cabinets

5.1 Place the left panel on the work-top or the ground

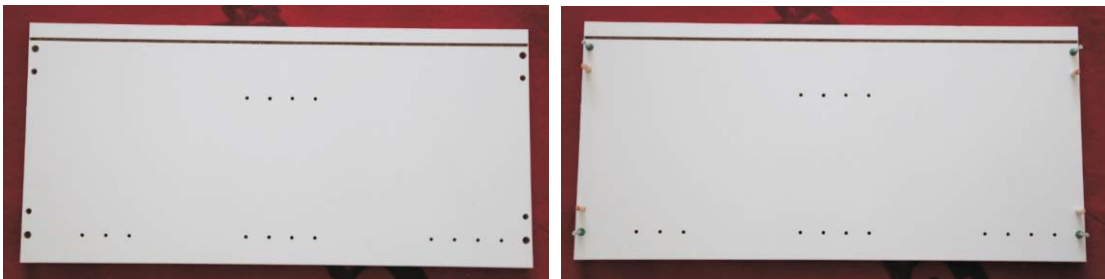

5.2 Connect the bottom panel to the left panel

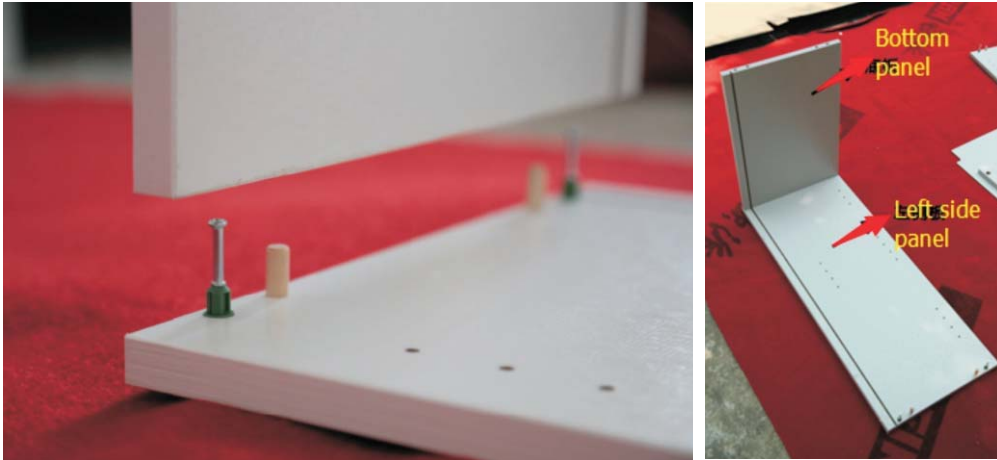

5.3 Fix the left panel and the bottom panel with eccentric wheel



5.4 Connect the top panel to the left panel

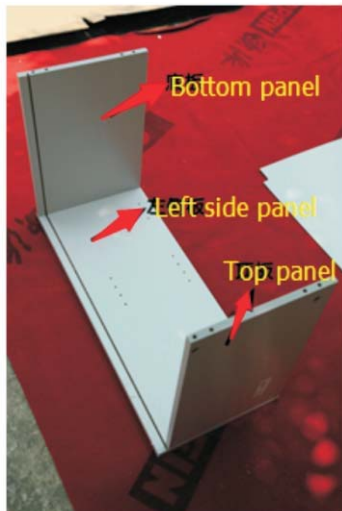

5.5 Fix the left panel and the bottom panel with eccentric wheel



5.6 Connect the right panel to the bottom panel and top panel, like the picture shows



5.7 Fix the left panel and the bottom panel with eccentric wheel



5.8 Insert the back panel



5.9 Use the 15mm screw to fix the back panel

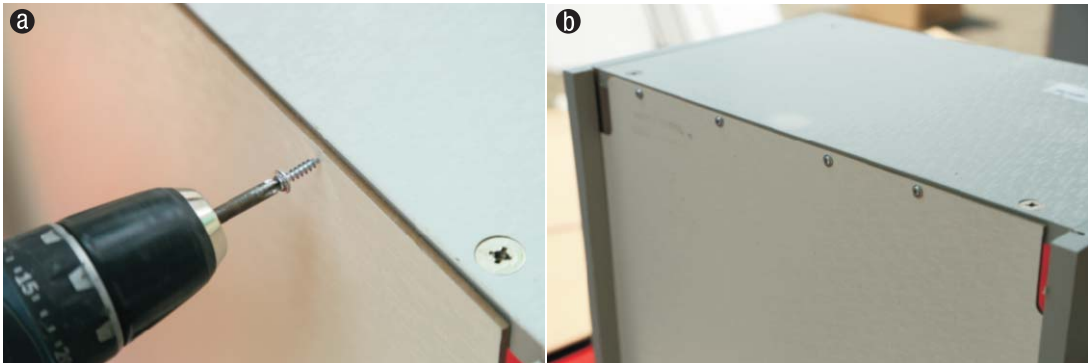

5.10 Fix the bracket with 30mm screw

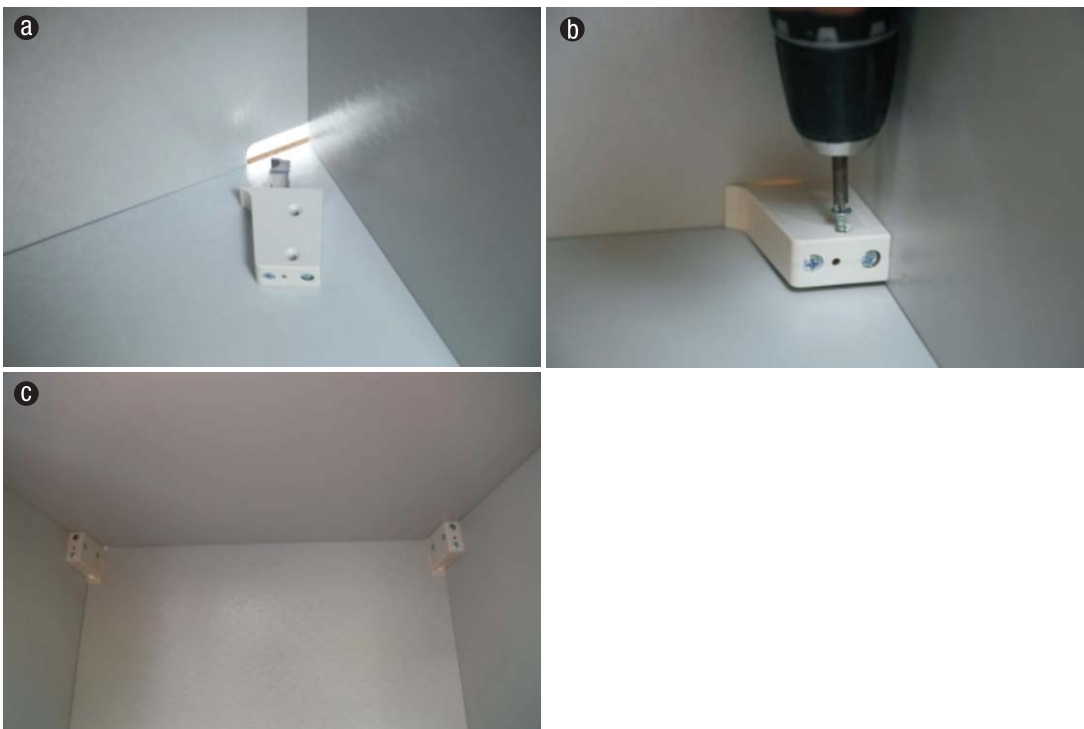

5.11 Install the shelves

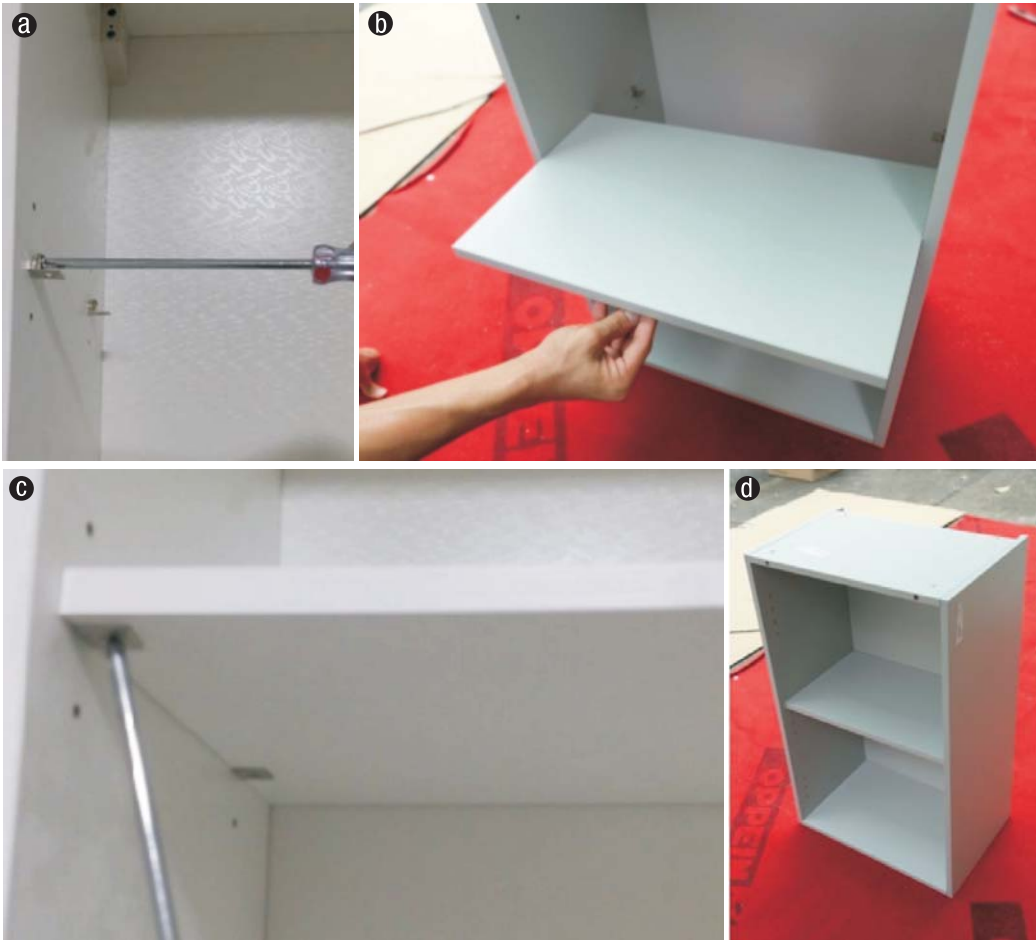

Remark: Strengthened stripe is needed when the $W \geq 600\text{mm}$ of the wall cabine

7 Install the Wall Cabinet

7.1 Install the hanging bracket

50mm=ceiling height

60mm=space between top panel to the bracket

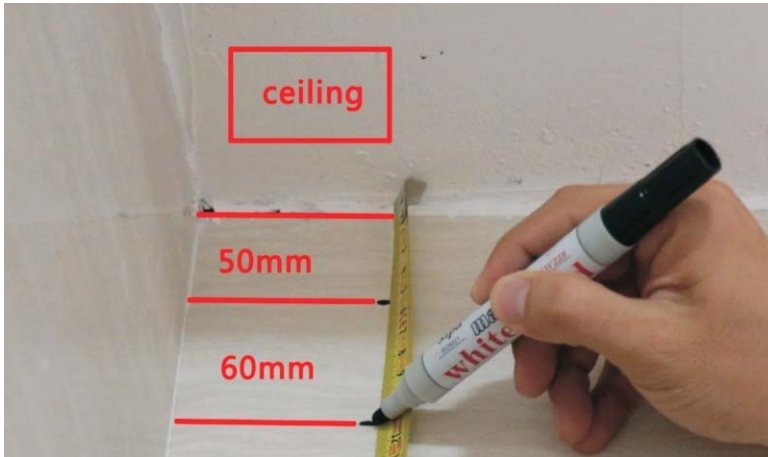

20mm=side panel width of the wall cabinet

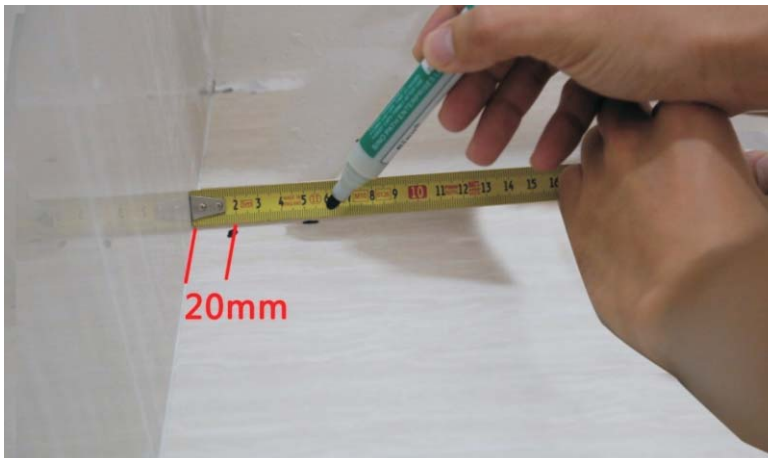

7.1 Install the hanging bracket

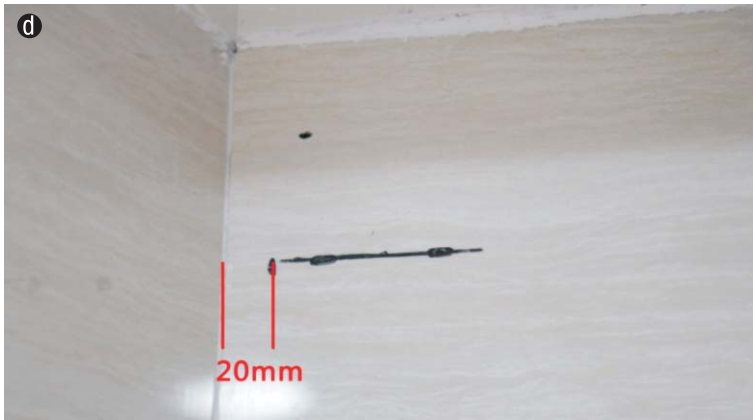
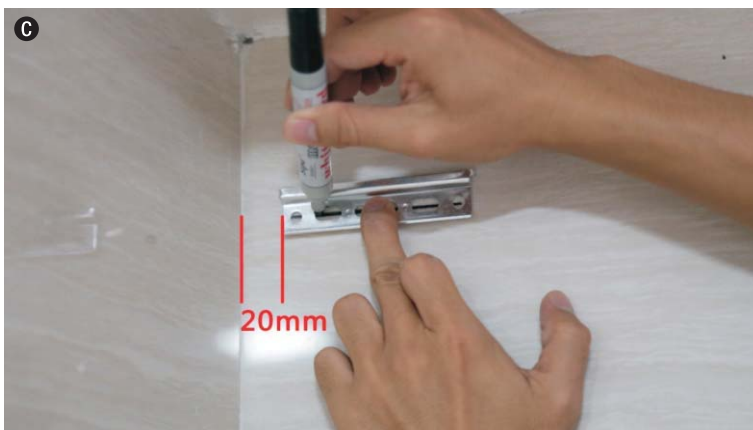

7.1 Install the hanging bracket



7.1 Install the hanging bracket



7.2 Drill a hole on the back panel

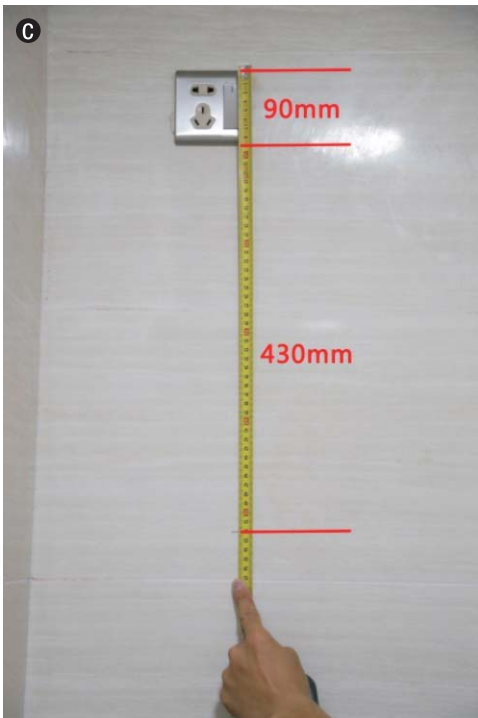
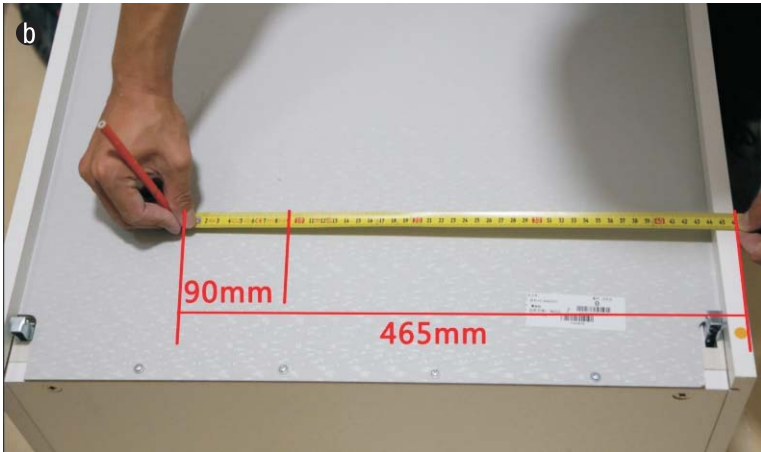

7.2 Drill a hole on the back panel

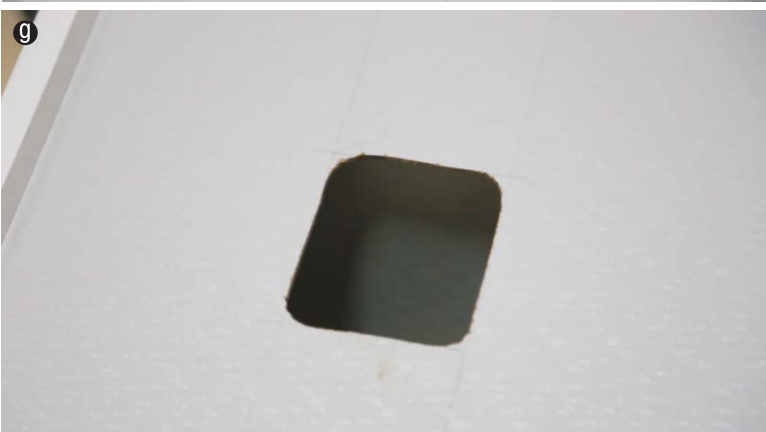
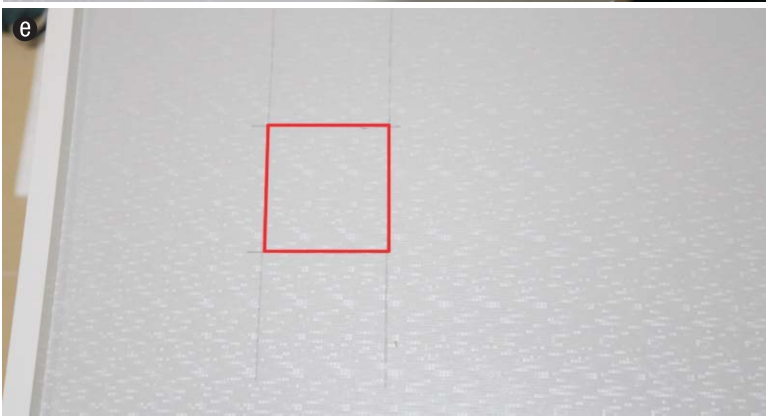
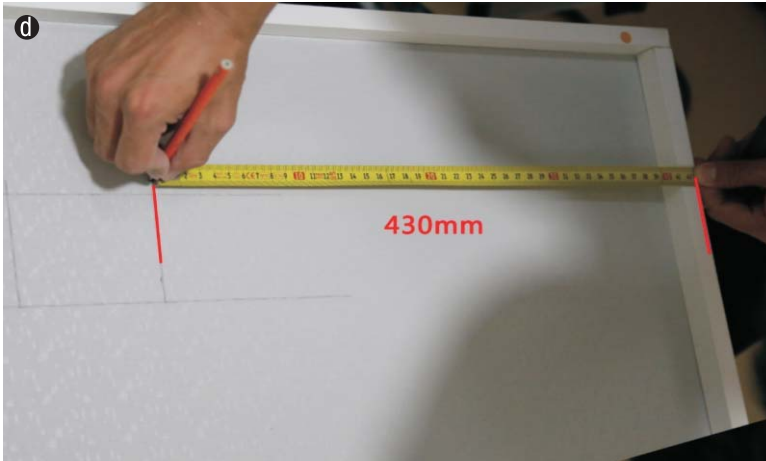

7.3 Install the wall cabinet to the bracket



7.4 Adjust the bracket to make sure that the cabinet are in line with the ground

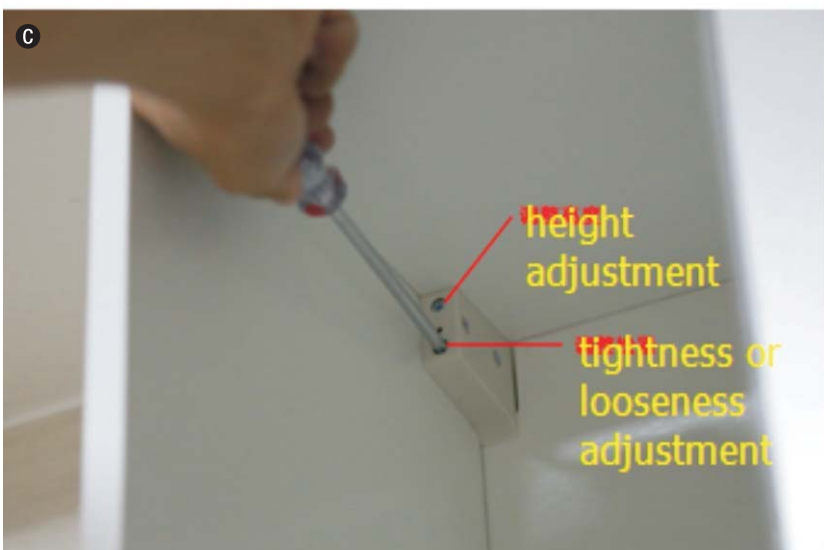

7.5 Fix the adjacent cabinets



8 Install the Base Cabinet

8.1 Set a line on the wall in line with the ground



Confirm the position of each cabinet according to the drawing.

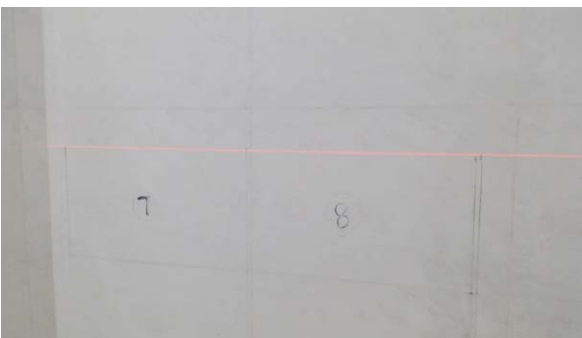

10.1.2 Fix the hinge to the door panel



10.1.3 Fix the base to the door



10.1.4 Adjust the hinge.(the front one is for moving back and forth, and the back one is for moving right and left)

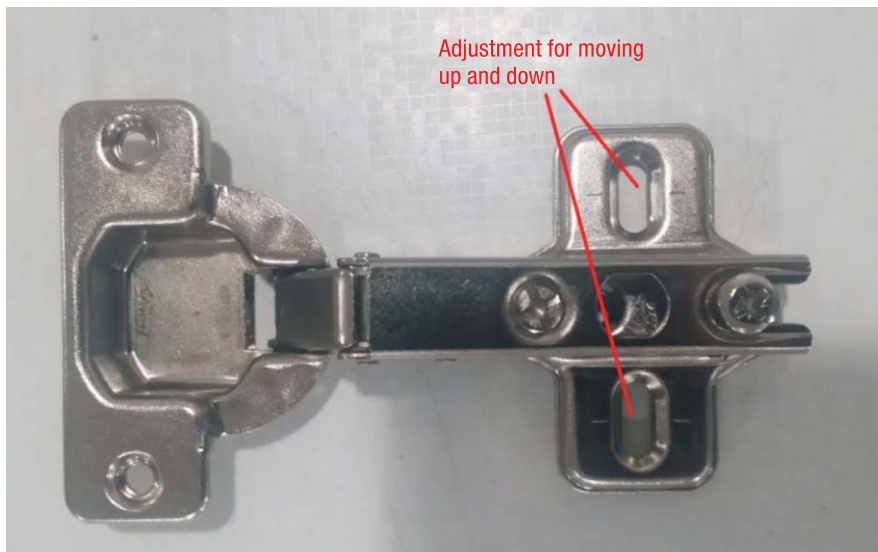
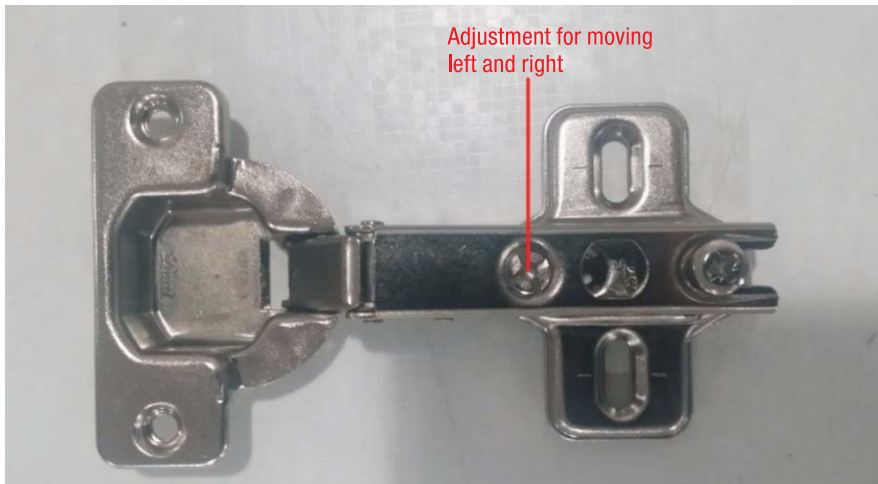

10.2 Install the Door Panle

10.2.1 Fix the idle hole insert to the holes. (Only modular cabinet has got the system holes)



10.2.2 Make sure the door is in line with the bottom part of the cabinet, then fix it to the carcase



10.2.3 If the doors are not in the same line after fixing, then we need to adjust the doors

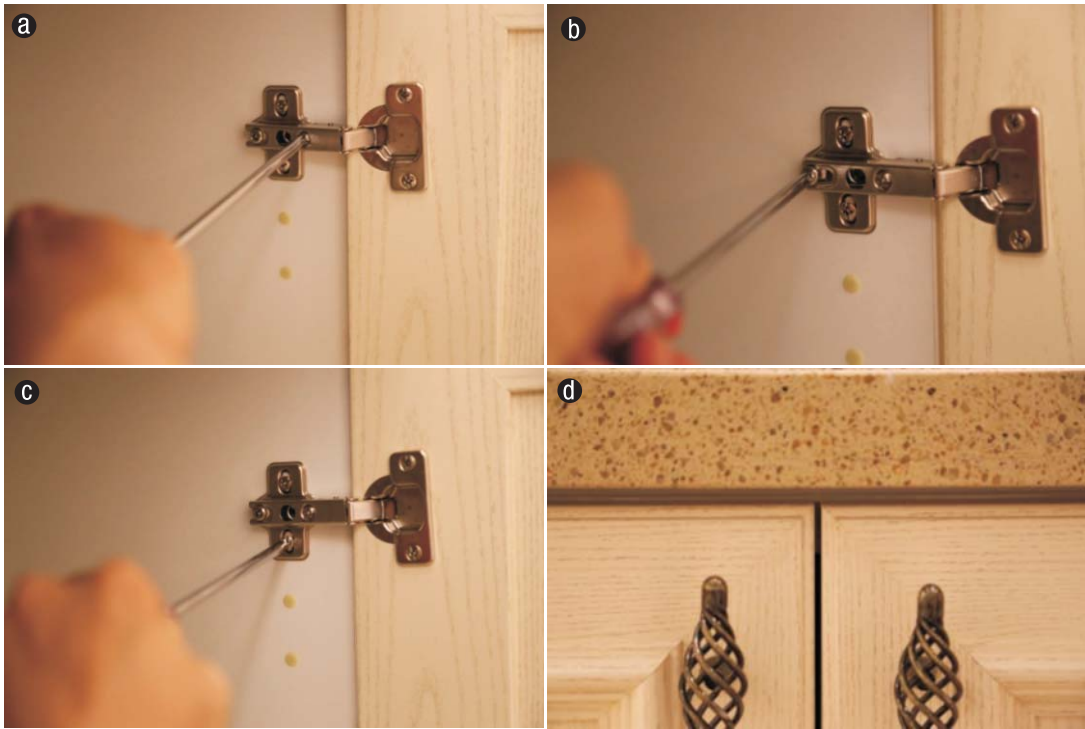

10.2.4 Install the hinge cover after adjusting the door



10.3 Install the Handle

Fix the screw to the door



10.4 Install the Kickboard

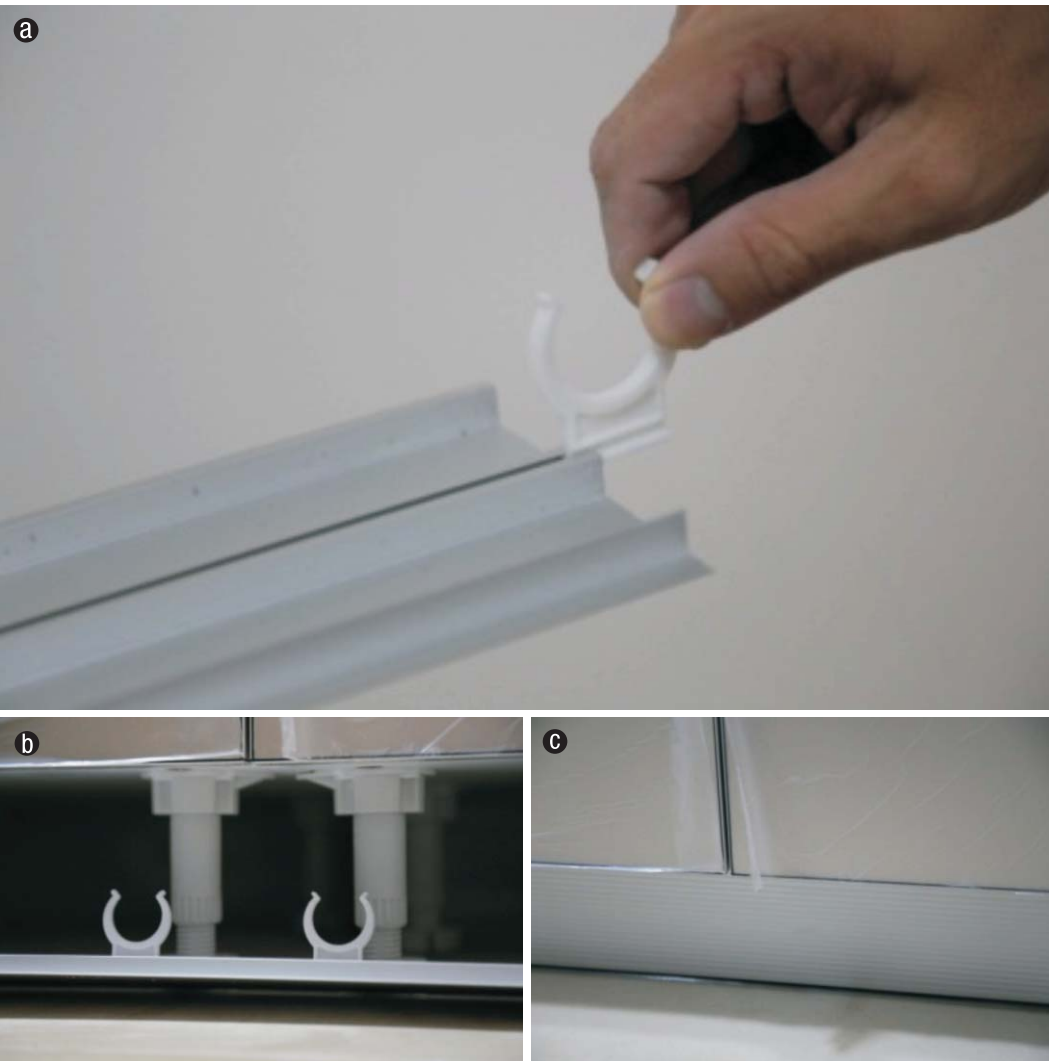

10.5 Install the buffer

Install BM-H02 with exterior cover in the interior part of the side panel



Install the buffer BM-H02 in the buffer hole



10.6 Install the plastic buffer insert

To protect the carcass when close the door



11 Clean

Clean the cabinets and the countertops

